

TOSO KI LIU

APR - JUN 2025 QUARTERLY NEWSLETTER



Visitation to the State House was conducted to update His Excellency of what TLTB is doing

"I'm Happy to see TLTB progressing well": Lalabalavu

The iTaukei Land Trust Board (TLTB) Management Team visited the President of Fiji, His Excellency Ratu Naiqama Lalabalavu, at the State House.

Led by CEO, Mr. Solomon Nata the team went to update the President on the work TLTB is doing – including improvements in land services and how the Board is working more closely with iTaukei landowners across the different provinces, Tikina, villages and landowning units.

Mr. Nata gave a short presentation on TLTB's current programs, new business direction, and how they aim to better serve the iTaukei.

President Ratu Naiqama thanked TLTB and its leadership team for their hard work.

"I'm happy to see the progress and the direction you're going in," he said. "I really like how you're now reaching out more

to landowners. This shows that TLTB is moving forward."

The President also talked about the important history of TLTB – reminding everyone that it's the only Board in Fiji that was originally linked to the British Crown when it was created in 1940.

He said it was sad that the President's role in the Board was removed by the previous government.

He encouraged TLTB to keep showing strong leadership and to help landowners make better decisions for their land and their future.

"This is a great time for TLTB to grow and become even better," he added.

"When a place is truly blessed, you will see it in the way people work together, services improve, and partnerships grow. That's what we're seeing at TLTB," he said. ■

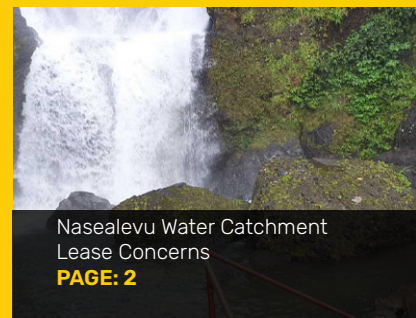

Nasealevu Water Catchment Lease Concerns

PAGE: 2



Taukei Woman Thrives in Homestay Business in Kadavu

PAGE: 6



South Pacific with First-Ever Quantum Systems Trinity Pro Drone

PAGE: 11



Varavu Subdivision in Ba nearing completion

More for Landowners in 2025: Varavu Subdivision in Ba

The iTaukei Land Trust Board (TLTB) has stepped into 2025 with a renewed purpose: to do more for landowners and ensure they benefit directly from the development of their land.

One of the key highlights this

year is the Varavu Residential Subdivision in Ba — a major land development project fully funded by the Board.

Location: Varavu, Ba
Landowning Unit: Tokatoka
Masekonalagi, Mataqali
Yasawa of Sorokoba Village

Subdivision Details:
26 lots across 9.75 acres of native land
Each lot ranges between 800 to 1000 square meters

With 90% of the works being completed, this project represents more than just real

estate — it's an investment by landowners, for landowners, through the support of TLTB. It's also part of a bigger direction in 2025 to put iTaukei landowners first, generate sustainable returns, and turn land into lasting opportunity. ■



The Nasealevu Water Catchment Area in Labasa

Nasealevu Water Catchment Lease Concerns

The iTaukei Land Trust Board (TLTB) has taken proactive steps to address concerns raised by the landowners of the Nasealevu Water Catchment Area in Labasa regarding the lease agreement with the Water Authority of Fiji (WAF).

The landowners had raised several issues, including the construction and maintenance of an access road leading to their village, clarity on the lease issuance process, distribution of lease monies, and the verification of lease approvals. Additionally, they requested a Forest Inventory by the Department of Forestry to ascertain the value of merchantable timber and the construction of 12 fishponds as compensation

for the environmental impact caused by dam construction.

In collaboration with relevant stakeholders, TLTB has conducted multiple joint consultations with the landowning unit (LOU) members at Nasealevu village and the following resolutions have been made:

Access Road Construction: WAF has agreed to construct and maintain the access road, as they were previously unaware that this was a condition requested by the LOU.

Lease Documentation and Transparency: All requested information regarding the lease issuance process was provided to the LOU during consultations. TLTB

also supplied a copy of the lease title and detailed lease statements for the four Mataqali within Yavusa Nasealevu—Luvutu, Vatuwa, Nasealevu, and Logani.

Merchantable Timber Inventory: The Department of Forestry has agreed to conduct an inventory assessment to determine the value of merchantable timber within the leased area.

Fishpond Feasibility Study: The Department of Fisheries conducted a feasibility study on the proposed fishponds. The study determined that the water overflow from the dam could only sustain three fishponds instead of the 12 initially requested by the landowners. This outcome has led to some

dissatisfaction among certain LOU members.

Concerns have also been raised over the involvement of an external consultant who has been reportedly influenced some LOU members to challenge the legitimacy of the lease title and disrupt water access at the Nasealevu catchment. The matter has now been escalated to the Commissioners' Office for further handling.

TLTB is working very closely with the LOU to address their concerns in an amicable manner. However, landowners have been advised against any actions to disrupt the Nasealevu Water Catchment. ■



Hon. Ifereimi Vasu with Landowners from the North-West and South-West Region with their TDF-funded machines

\$295,000 Worth of Machinery Awarded Under TDF.

In a significant step towards landowner empowerment and economic self-sufficiency, the iTaukei Land Trust Board (TLTB) handed over machinery worth \$295,000 to four landowning unit (LOU) groups in a ceremony held in Nadi yesterday.

The event was officiated by the TLTB Chairman and Minister for iTaukei Affairs, Hon. Ifereimi Vasu. Speaking at the ceremony, Hon. Vasu highlighted the importance of economic empowerment through practical investment in tools and resources:

"This initiative is more than just a handover of machines. It represents the empowerment of our people to take ownership of their land, to build sustainable livelihoods, and to grow their own economies." The four LOUs that received assistance today are:

1. Mataqali Nacobicibici Trust

Mataqali Nacobicibici Trust from Nasavusavu Settlement in Nalawa, Ra.

Mataqali Nacobicibici have been approved an advance of \$70,000.00 to purchase a Tractor and working capital to assist with their cane farming operations.

They have already leased an area of 84 hectares of land for sugarcane farming.

2. Mataqali Duaira

Mataqali Duaira represents one of the landowning units within the Yavusa Nabuna, Nabuna village, situated in the Tikina of Tavua, Ba.

Mataqali Duaira Trust have been approved an advance of \$61,000.00 to purchase a tractor to assist with their cane farming operations.

Members of the Mataqali have been engaged in cane farming with approximately 198 acres been cultivated.

3. Yavusa Leweisavu

Yavusa Leweisavu in Momi Village, Tikina Momi, Nadroga have been approved advanced of \$79,000.00 for the purchase of a Tractor and Working Capital.

They have 1000 acres of vacant land which will assist them in their cash crop and cane farming operations.

4. Tokatoka Bitowai Trust

Tokatoka Bitoiwai, Mataqali Leweivalaga is one of the landowning units in Yavusa Leweiwai in the village of Nabila Village Momi, Nadroga.

The Trust has been approved advance of

\$85,000.00 for the purchase of 3 tonne Truck to transport school children in their community and assist in transporting villagers to the market to sell their produce.

CEO, Mr. Solomon Nata, reaffirmed the organisation's commitment to helping landowners transition from passive land leasing to active participation in the economy.

"Through the TDF, we are addressing a key challenge that landowners have faced for years – access to capital. By investing in them, we're not just giving machines; we're creating opportunities for generations."

The iTaukei Development Fund reflects TLTB's vision to drive transformation and innovation among landowners, ensuring they are not just custodians of land, but also key players in Fiji's national development. ■



CEO Mr Solomon Nata with LTC executives

MOU With Lami Town Council

The iTaukei Land Trust Board (TLTB) and the Lami Town Council (LTC) officially signed a Memorandum of Understanding (MOU) to strengthen collaboration and improve service delivery for our tenants and the wider Lami community.

CEO Mr Solomon Nata said this partnership marks a significant milestone as we

unite in our commitment to sustainable development, efficient municipal services, and enhancing the quality of life for all residents within Lami Town's municipal boundary.

Representing Lami Town Council were:

- Chairman – Mr. Vula Shaw
- Special Administrator – Mr. Tirath Sharma
- Acting CEO – Mr. Azam

Khan

What the MOU Means:

- Closer collaboration on shared challenges and opportunities
- Improved data and information sharing (where

appropriate)

- Joint initiatives on staff training, capacity building and awareness programs
- Regular consultations on matters of mutual interest
- Establishment of a joint committee to facilitate the

goals of this partnership

TLTB currently administers 639 leases within Lami Town across various land types and purposes. This agreement is another step toward ensuring our tenants receive timely, transparent,

and effective services.

Together, we are building a stronger, more resilient Lami Town — one that reflects the spirit of trust, partnership, and progress. ■



Rent Arrears Drive ... at the Mellineum Subdivision in Nausori

Rental Arrears Reduces By \$9.6m in 6 Months

The iTaukei Land Trust Board (TLTB) has successfully reduced its national rental arrears from \$31.6 million as at 1st January 2025 to \$22 million by 30th June 2025. This marks a significant reduction of \$9.6 million — representing a 30.45% decrease in just six months.

CEO Mr Solomon Nata said this achievement reflects TLTB's firm commitment to fulfilling its legal obligation of collecting rent and ensuring

that landowners receive what is rightfully theirs from the use of their native land.

"This achievement was made at the back of an aggressive arrears recovery strategy that involves getting courts orders for disconnection of utilities and vacant possession of leased land across the country," he added.

Despite this progress, TLTB continues to urge tenants with long-outstanding arrears — some dating back 10 to 20

years — to settle their dues without further delay. These arrears cover all lease types and affect every region: Northern, North-Western, South-Western, and Central Eastern.

Failure to pay will result in legal enforcement, which may include:

- Applications for the disconnection of utilities, and
- Vacant possession of leased land, as ordered

by the courts.

TLTB reiterates its willingness to assist tenants through structured payment plans and encourages affected individuals or businesses to engage directly with TLTB offices.

For further information or to make payment arrangements, please contact the nearest TLTB office or call our customer service centre. ■



Keyboard Warriors caught off guard

TLTB Clarifies Land Consultation Concerns Raised On Facebook

The iTaukei Land Trust Board (TLTB) wishes to clarify concerns raised in a social media video posted on 12 April 2025 by Mr. Mala Vuetibau regarding the alleged lack of consultation in the subdivision of a parcel of land located in Wainibuku, Kalabu.

The lease in question, originally issued for agricultural purposes, is situated on land owned by Mr. Mala Vuetibau of Kalabu for 3.1364 hectares. Following multiple inspections and stakeholder consultations, the Board re-entered the lease in 2024 due to significant breaches of lease

conditions, including the absence of cultivation and the presence of multiple unauthorized dwellings and a church.

Since February 2023, TLTB has undertaken the following:

Four consultations with members of Mataqali Ulivi between May 2023 and February 2024 regarding the re-entry process and the proposed residential subdivision.

The Mataqali was fully informed and had expressed their support for the relocation of tenants affected by EFL Wayleave leases to the new subdivision.

Re-entry of the lease was officially registered on 18

April 2024, after which planning commenced for the development of residential lots. In response to Mr. Vuetibau's claims, TLTB conducted a follow-up consultation on 14 April 2025. Present at the meeting were Mr. Vuetibau, other landowners, and TLTB officials, who provided clarification on the consultation processes and the subdivision development.

It was confirmed that Mr. Vuetibau did not attend the earlier consultation meetings, which may have contributed to his misunderstanding. TLTB presented documented meeting minutes as evidence of engagement and transparency with the landowning unit (LOU).

The meeting concluded with the following outcomes:

Formalisation of occupation on new leases two residential lots to the previous tenants, Mr. Ulaiasi Halofaki and Ms. Kesaia Tavaga, a church and two other occupants, subject to payment of premium, rent and costs.

The relocation of leases affected by EFL infrastructure will remain a priority.

Remaining lots will be held in abeyance pending further discussions with the LOU on their development plans.

Landowners have requested that agricultural leases nearing expiry be returned for incorporation into their

own land-use plans.

TLTB reaffirms its commitment to transparent consultation and development planning with landowners. Future requests from the Mataqali will be supported by land use planning assistance from TLTB. Landowners are encouraged to work together with TLTB on their development plans for better coordinated and sustainable land use and to consult with TLTB office first before spreading misinformation to the public.

Mr. Vuetibau has made some serious allegations that are libellous in nature, however he has apologised to our officers in yesterday meeting and was accepted.

Long - Standing Issue with Mataqali Navunibua

The iTaukei Land Trust Board (TLTB) is pleased to share that a long-standing land compensation matter with Mataqali Navunibua of Nayavu, Wainibuka has now been successfully resolved.

The Mataqali had raised a claim for royalty payment for gravel that was extracted from their land by the Public Works Department (PWD) back in 2008–2009 during the construction of the Kings Highway.

Due to a record error, the royalty payment made at that time was mistakenly allocated to a different Mataqali. After a thorough review and legal discussions,

TLTB has today paid the outstanding \$150,000.00 to the Turaga ni Mataqali and Mataqali Navunibua Trustees – bringing closure to this long-standing matter.

This also marks the end of a High Court case filed by the Mataqali in 2019, which was formally settled through a Deed of Settlement in December 2024.

We thank Mataqali Navunibua for their patience and cooperation throughout this process. The Board remains committed to working with all landowners to ensure fair, transparent, and respectful administration of iTaukei land for the benefit of our people. ■



Hon. Vasu presenting the compensation to the LOU



Muanivatu Trails ... very successful

Vuadomo's Rise With Muanivatu Trails

In the lush highlands of Savusavu, the Vuadomo clan is creating a future of opportunity through Muanivatu Trails, a sustainable eco-tourism venture. With TLTB's support, they've harnessed the value of their land to preserve their environment while empowering their people.

The Vuadomo community knew their land held great potential, but for years, outsiders reaped the benefits. When Muanivatu Trails emerged, TLTB stepped in to help secure the eco-tourism lease, allowing them to develop their land in a way that respects their culture and values.

Through a \$30,000 low-interest loan from TLTB, Muanivatu Trails was able to build a wellness center, spa, and other key facilities. They have successfully repaid the loan, demonstrating not only their commitment but their ability to grow sustainably. This investment has boosted jobs, increased revenue, and raised their tourism lease value to \$1 million FJD—a true reflection of the

community's hard work and dedication.

Looking forward, the Vuadomo clan is preparing to develop 99 acres, including accommodation villas, family homes, and a commercial center. Construction of new tourism facilities starts this month, setting the stage for even more growth.

The Muanivatu Trails team

shared:

"We are grateful for the support from TLTB, which has been a cornerstone of our success. Thank you for believing in us."

We say: Vinaka vakalevu for believing in TLTB. When landowners lead with vision and commitment, great things can happen.

At TLTB, we remain committed to empowering communities to turn their land into a lasting opportunity. Muanivatu Trails is a shining example of what's possible through unity, support, and planning.

To all our landowning communities: Your land holds the power to transform your future. Let's build it—together. ■



Tourist started recognising BNB at Namuana, Kadavu

Taukei Woman Thrives in Homestay Business in Kadavu

Situated in Namuana Village, Tavuki, Kadavu. Ms Mereoni Vuase currently operates a home staying business that caters for tourism and even for local travellers including civil servants, that visit the island of Kadavu.

Located approximately two (2) kilometers from the Vunisea Government Station and 2.5km from the jetty, the homestay business boasts its central location and a stunning view by the beach allowing guests to witness the sunrise every morning and sundown every evening after a long day of work.

Commencing in 2022, the business provides three (3) rooms consisting of one (1) single bed and one (1) bed bunk to accommodate the

influx of visitors to the island.

To add on, the business provides a free laundry service as part of the package.

Being an iTaukei Woman, and a member of Mataqali Namuana, Ms Vuase excels in her hospitality service in utilizing the natural resources available.

"I do not spend a lot on food as most of the produce are from my plantation and from regular fishing out at sea" Cooking twice a day for guests, Ms Vuase always ensures that her guests are well fed in the morning as some may travel for long hours either by boat or by car.

"I normally prepare breakfast and dinner guests as they are

usually out visiting villages throughout the day and return right in the evening".

Upon discussions with Ms Vuase, she shared that her driving force behind the business would be her Faith as a Seventh Day Adventist and her vision of providing a better life for her family.

"At the time, I was unemployed, living in the village, and struggling to make ends meet. Setting up this business three years ago has allowed me to provide a better life for my family while also providing an income stream that assists in our daily living."

"I thank God for opening this opportunity business for me as it has also allowed me to network, interact and

socialize with guests from all walks of life.

Ms Vuase shared that despite the challenges faced, she hopes to renovate existing structures and expand the business in order to cater for the demands and bookings of guests visiting the island.

Looking at her operations, Ms Vuase is eligible to secure funding through the iTaukei Development Fund Facility; something that TLTB will pursue with her very shortly.

Ms. Vuase plans to include additional rooms and have two (2) of the existing rooms converted into master bedrooms. These master bedrooms will have their own showers and restrooms with extensions to her kitchen and dining area. ■



Taukei Plaza Dua in the heart of Lautoka City

Taukei Plaza Dua- A New Chapter for TLTB

The iTaukei Land Trust Board (TLTB) proudly marked a significant milestone today Monday, 28th April 2025, with the official blessing and occupation of its new North-West Regional Office at Taukei Plaza Dua – the first TLTB-owned building acquired under its New Business Direction.

CEO Mr. Solomon Nata described the occasion as a very special moment and a significant milestone for TLTB and all landowners across Fiji.

“The key to this achievement

is the realization that as members of the iTaukei community, we have the ability to own properties in major towns and cities,” he said. “TLTB is taking the lead, paving the way for landowning units (LOUs) and iTaukei individuals to embrace the idea – and believe – that we can own and operate businesses wherever and whenever we choose.”

The special occasion was led by Reverend Savirio Vuata, Talatala Qase Wasewase Namoli, who conducted a small but meaningful

church service attended by the Lautoka office staff. During the service, Rev. Savirio delivered an inspiring message from the book of Genesis, reminding the team that just as God entrusted man to manage and protect the Garden of Eden, TLTB staff are likewise entrusted to manage, protect, and serve the landowners of Fiji.

Following the service, the staff officially began their operations from the new premises; with 12 more office spaces open for rent in the heart of Lautoka City. The new

office is now fully operational, with the North-West team ready and committed to continuing their service to landowners and stakeholders with renewed energy and purpose.

This move represents not just a new physical space, but a fresh chapter in TLTB’s journey towards growth, empowerment, and excellence in service delivery.

TLTB’s second building: Taukei Plaza Rua, is expected to be ready by June 2025 in Namaka, Nadi. ■



Tui Namosi .. Ratu Suliano Matanitobua

New TLTB Service Centre in Namosi - A Province With Significant Development Potential

The iTaukei Land Trust Board (TLTB) reached another milestone in its new business direction yesterday (30th April 2025) with the official opening its third service centre – in Dada, Namosi, by the Turaga na Tui Namosi, Ratu Suliano Matanitobua.

Located within the premises provided by the Ministry of Rural and Maritime Development, the Dada TLTB Service Centre is set to bring vital land services closer to the people of Namosi – particularly the five tikina of Wainikoroiluva, Naqarawai, Veinuaqa, Namosi, and Veivatuloa. This includes 72 mataqali from 28 villages

across 77,917 hectares of native land.

In his address, Turaga na Tui Namosi, Ratu Suliano Matanitobua, thanked the TLTB Board and its Management Team for their leadership and vision and rendered his full support. He urged those TLTB staff that will be serving from the new TLTB office, to consider themselves part of the Namosi province.

“Whenever you set foot on the land of Namosi, count yourself as one of us so that you can serve my people better. Because you will drink its water and eat its food – and though you may not

always sleep well or eat well – it will not matter, because you are one of us,” he said.

Ratu Suliano said the new office would become a hub for opportunity, learning, and prosperity for the people.

“Namosi has a lot of potential. We can help each other create wealth and assist the economy. But we must do it with care and love for one another. All provinces in Fiji must work together for this common goal,” he said.

CEO Mr Solomon Nata said the event marked more than just an office opening – it symbolised the Board’s commitment to decentralise

services and extend outreach to remote and rural communities.

The new office will initially operate two days every fortnight, with the flexibility to increase operations based on local demand.

With only 16% of Namosi’s land currently under lease, Mr Nata noted that more than 65,000 hectares remain unleased and hold significant development potential.

“This office will help facilitate land use planning with our landowners, create new economic opportunities, promote development projects that can lift the

standard of living, and increase awareness of the assistance programs we offer such as the iTaukei Development Fund,” Mr Nata explained.

Mr Nata reiterated TLTB’s mission to not only manage leases, but to empower landowners with knowledge and confidence to drive economic growth.

“We want to encourage more of our landowners to farm and lease their own land; in ways that are sustainable, that respect our culture and traditions, and most importantly, that benefit our people,” he said.

Apart from its Head Office in Suva, TLTB now operates:

- Four Regional Offices in Suva (Central Eastern Region), Nadi (South-West Region), Lautoka (North-West Region), Labasa (Northern Region) and the Tourism Office in Namaka,
- Six Sub-Regional Offices in Nausori, Ba, Sigatoka, Rakiraki, Korovou, and Savusavu,
- And three Service Centres in Nabouwalu, Vunidawa, and now Dada. ■



TLTB supporting our youths going into formal higher education

USP April 2025 Graduation Ceremony

The iTaukei Land Trust Board (TLTB) was proud to sponsor the Award for the Most Outstanding Master of Commerce Thesis at the April 2025 Graduation Ceremony held by the University of the South Pacific (USP) at its Laucala Campus.

The prestigious award recognised high academic achievement, with recipients attaining a GPA of 4.0 and above. Each awardee received a gold medal and a cash prize, sponsored by supporting organisations. TLTB’s sponsorship of \$1,500 for the award reflects its commitment to promoting academic excellence and

investing in the future of Fiji and the region.

CEO Mr Solomon Nata said the sponsorship was part of the Board’s broader effort to support quality education, visibility, and inclusiveness in line with its core values and corporate mission.

“This award is more than just a recognition of academic excellence – it represents our commitment to nurturing future leaders and professionals who can contribute meaningfully to our communities and institutions,” Mr Nata said.

“Supporting education at this

level not only strengthens our ties with one of the region’s leading institutions but also creates a valuable recruitment pathway for TLTB to connect with top talent.”

This year, the award for the Most Outstanding Master of Commerce Thesis was jointly awarded to Ms Diviya Darshani Narayan and Ms Nitika Nand, who were celebrated during the official USP Graduation Ceremony in April.

Board Secretary Mr Salimoni Karusi presented the awards during the ceremony and congratulated the two recipients on their academic

achievement and dedication to excellence in their research.

USP expressed its appreciation for TLTB’s continued support, saying the partnership enhances opportunities for students while strengthening ties between the university and the wider professional and business community.

“We are honoured to be part of this occasion and proud to contribute in a meaningful way to the success of our students and the advancement of higher education in Fiji and the Pacific,” Mr Nata concluded. ■

EVICTON ORDER

Moves To Execute Eviction Orders

The iTaukei Land Trust Board (TLTB) is urging all leaseholders with overdue rent payments to urgently clear their arrears, or risk facing the consequences. This reminder comes as TLTB confirms that it will be taking steps within this week to execute eviction orders obtained from court, marking TLTB's ongoing commitment and efforts to lawfully recover rent owed to the iTaukei landowners.

TLTB CEO Mr. Solomone Nata, said the decision to proceed with executing the eviction orders was not taken lightly, but was necessary to uphold the rights of landowners who have waited far too long to receive the lease income that is rightfully theirs.

"We have exhausted all reasonable avenues including reminders, notices, and payment plan arrangements," Mr. Nata said.

"The unfortunate reality is that continued non-compliance by certain tenants forces us to act in the best interests of landowners. These funds are critical for the livelihood, development, and well-being of the iTaukei landowners."

As at 1 January 2025, the opening rent arrears balance stood at \$31.6 million. To date, this has been reduced to \$24.8 million – indicating a recovery of \$6.8 million so far. This means we still have \$18 million yet to be recovered for the landowners.

The Board remains fully committed to upholding fairness, transparency, and accountability in the lease management process, with a strong focus on ensuring compliance with all lease terms and conditions.

However, failure by tenants to meet their obligations undermines this mandate and affects the trust placed in TLTB to safeguard landowners' interests.

The eviction orders will be executed in accordance with the law and due process, and further action may be taken if arrears persist across other leases.

Tenants are reminded that leases are legally binding

and must be honoured to maintain good standing with TLTB. He also encouraged leaseholders to proactively communicate with their nearest TLTB office to settle their lease arrears and avoid further legal action.

"We do not wish to evict anyone – but our first duty is to the iTaukei landowners. We are calling on all defaulters to do the right thing and come forward before it's too late," he added.

TLTB urges the public and stakeholders to support this initiative to uphold accountability and ensure the rightful beneficiaries – the landowners – receive what is lawfully due to them. ■

\$2.75m Allocated for Construction of Access Farm Roads in Agriculture

Significant progress has been made by the iTaukei Land Trust Board (TLTB) on one of the major challenges for our agricultural leaseholders today – the lack of access roads to newly subdivided agricultural lots.

With combined funding support from the Fiji Government and the iTaukei Land Trust Board (TLTB), a total of \$2.75 million – comprising \$750,000 from Government and \$2 million from TLTB – has been allocated for the construction

of farm access roads across four key agricultural subdivisions: Navunibua (Naitasiri), Nabulula (Tailevu), Navunisorua (Naitasiri), and Kasavu (Naitasiri).

TLTB confirms that the Navunibua access road has been completed, while road works continue on the remaining three sites.

CEO Mr. Solomone Nata said, "This investment is a significant step in unlocking the full potential of iTaukei land for agriculture and



Farm access roads open up agricultural subdivisions

improving rural livelihoods”.

“We are grateful for the Government’s partnership and the TLTB Board of Trustees and remain committed to delivering this project on time and within budget.”

The current delay in the

completion of Nabulula, Navunisorua, and Kasavu roads is due to unfavourable weather conditions and the presence of creeks along the construction routes.

The contractor, under TLTB’s close supervision, is actively working on mitigation measures to ensure progress

continues steadily.

The project is on track for completion by the end of June 2025, before moving to the next phase, which includes road gravelling and culvert installation.

“This initiative is about more than just roads,” Mr. Nata

added. “It’s about opening pathways to economic opportunity, empowering landowners, and providing the necessary infrastructure that will attract investors and enable farming activities to thrive.” he added. ■



CEO Mr Solomone Nata speaking to the diaspora at the UK Roadshow

Empowering the iTaukei in the United Kingdom

The iTaukei Land Trust Board (TLTB) is part of a government delegation currently making its way through the United Kingdom as part of the Fiji-UK Roadshow 2025 organised by the Ministry of iTaukei Affairs.

Over the course of the last two weeks, the TLTB team led by TLTB Chairman and Minister of iTaukei Affairs and other government agencies are visiting Fijian communities in key cities including Abingdon, Stoke-

on-Trent, Cottesmore, Catterick, Edinburgh and Inverness on Thursday (UK’s time) to create awareness on what the Government is doing in terms iTaukei empowerment, language and culture, land utilisation, resource development, entrepreneurship, investment and commerce.

CEO Mr Solomone Nata said this is a celebration of connection, identity, and shared future; giving an opportunity to our relatives

abroad an opportunity to empower them and their children.

Other services that the team has been providing on site include births, deaths and marriages (BDM) registrations and Vola ni Kawa Bula (VKB) entrance and omission of deaths, services provided by Immigration & FNP, Elections office FHUT, TTFB with The Commercial Arm of TAB, etc

The exercise will continue in Gloucester, Plymouth and

then finally wrapping up with a major two-day event in London on Monday 19 and Tuesday 20 May.

The presence of TLTB is meaningful, as many Fijians living abroad wish to remain involved in their vanua – from leases and estate planning to development and even to starting a business; Fijians across the UK are encouraged to come out in numbers and make the most of this special opportunity to engage directly with our officers. ■



Farm Mechanisation is the way to go

New Tractor Allows Farming Efficiency for Duaira Trust in Tavua

The iTaukei Land Trust Board (TLTB), through its Taukei Development Fund Facility (TDFF), has provided financial support to the Duaira Trust of Mataqali Duaira, one of the landowning units of Nabuna Village, in Tavua.

The \$61,000 funding allows Duaira Trust to purchase a brand new tractor, significantly modernizing their farming operations.

Mataqali representatives Mr Sainivalati Nasau said this investment has streamlined land preparation and other essential farming tasks, leading to greater efficiency and long-term sustainability for the landowning unit.

“To date, the mataqali has successfully cultivated up to four acres of land out of the 198 that they have using the

new machinery, supporting both sugarcane farming and the cultivation of watermelon. This dual-crop approach marks a strategic move toward diversification and enhanced land productivity,”

he added.

The tractor has reduced their reliance on external contractors and empowered the trust to manage operations independently.

This initiative underscores TLTB’s continued commitment to empowering iTaukei landowners through financial assistance and sustainable development programs. Through the TDFF

scheme, TLTB is encouraging landowning units like Mataqali Duaira to actively engage in productive land use that fosters economic growth. ■



Naitasiri landowners now getting a feel of hat they can do when they lease their own land

Empowering the Landowners: A New Dawn For Naitasiri

The iTaukei Land Trust Board (TLTB), through its Landowners Division, has taken a bold step forward in landowner empowerment with the launch of its very first Landowning Unit (LOU) Workshop for 2025. Held under the powerful theme, “Empowering Landowners for Successful Implementation & Sustainability of Development Projects,” the workshop brought together 57 landowners from 14 landowning units (mataqali) in the Tikina of Soloira, Naqaravakawalu, Viria, Navuakece and Nabaitavo in Naitasiri, at Navatukia Village, Serea on Thursday, 15 May.

This initiative is part of TLTB’s ongoing commitment to help landowners move from potential to prosperity by unlocking the value of their land through knowledge,

collaboration, and action. This was done in collaboration with relevant Ministries that were presence to provide awareness and advice on the technicality and relevancy to be undertaken to ensure successful implementations of projects.

The workshop began with a heartfelt sharing and an inspiring address from Senior Landowners Officer, Mr. Pio Raitoni. Sharing his own observations from a recent trip to the Maori in New Zealand, Mr. Raitoni spoke passionately about indigenous communities there—scarce resources with immense development owned by the Maori or tribe through structural planning. His message to the people of Naitasiri was simple but profound:

- Form a committee of Trustees within each Mataqali
- Create a long-term development vision
- Profile and understand the true potential of your land
- Tap into support systems like the iTaukei Development Fund Facility (TDFF)
- “You own the land—now own your future,” Mr. Raitoni urged.

The second part of the workshop featured key presentations from Government and development partners, including the Ministry of Agriculture, the Ministry of Fisheries, and the Department of Cooperative, among others. These partners provided practical guidance on sustainable land use,

funding opportunities, and income diversification.

Most inspiring were the landowner success stories shared—examples of progress from Mataqali Waimaro of Navoka village, Nabaitavo and Mataqali Navitilevu of Vatukorosia village, Navuakece. These were not just stories—they were blueprints for change.

The final part of the program was the handover of the Asset Capitalisation reports to the fourteen (14) Mataqalis who attended the workshop. The report covers Landowning unit profiling and the Landowners’ Advisory Plan. The document is important for engaging with development partners to develop their resources and access funding through the TDFF or others of their choice.

South Pacific with First-Ever Quantum Systems Trinity Pro Drone

The iTaukei Land Trust Board (TLTB) has achieved a historic milestone by becoming the first institution in Fiji and the South Pacific to acquire and operate the Quantum Systems Trinity Pro drone—one of the most advanced surveying drones in the world today.

This breakthrough was demonstrated during a high-resolution topographic survey conducted in the Seaqaqa rainforest, where TLTB’s Geospatial Information Coordinator and certified drone pilot, Mr. Isireli Buwawa, led the mission.

The state-of-the-art drone,



Our drone pilot with the new Trinity Pro Drone

equipped with a LiDAR module and powered by Quantum-Skynode autopilot technology, was deployed to map the Mataqali Waisavulu boundary—a critical component of the Fiji Hardwood Corporation Limited’s upcoming forest certification project. With centimeter-level accuracy, the drone captured detailed 3D models of the terrain, revealing streambeds, erosion-prone areas, and

ancient terraces hidden beneath the dense forest canopy.

“This drone is more than just a flying camera—it’s a game changer for environmental and land-use planning across the region,” said Mr. Buwawa. “It enables us to capture data in just 60 minutes that would otherwise take weeks of manual fieldwork.”

The Trinity Pro’s VTOL (Vertical

Take-Off and Landing) capabilities, combined with a 60-minute flight endurance and dynamic terrain-following technology, make it ideal for Fiji’s rugged landscapes. It is the first of its kind in the South Pacific, with swappable payload options including high-resolution RGB, multispectral, thermal, and LiDAR sensors.

This innovative leap aligns with TLTB’s commitment to

modernize its operations and empower landowners through smarter data-driven decisions for sustainable development.

“We’re proud to be leading the way in digital transformation and geospatial intelligence in Fiji,” said CEO Mr Solomone Nata. “This investment reinforces our role in ensuring secure, accurate, and environmentally sound land management for all stakeholders.” ■



Vunitavola Subdivision in Tailevu ... one of the new TLTB land development project

Vunitavola Subdivision – Nearing Completion

The iTaukei Land Trust Board (TLTB) is proud to announce that the Vunitavola Subdivision in Tailevu is now 90% complete and just weeks away from finalisation.

- Fully-fledged residential subdivision
- Tarsealed roads
- Water and power supply connected
- Surveyed titles ready for issue

The subdivision comprises:

- 24 residential lots
- 2 commercial lots

Total Project Cost: \$1.76 million

What was once used for rice cultivation has now been transformed into a promising residential development – thanks to the collaboration between the Mataqali Vunitavola of Maumi Village in

Dravo (Tailevu) and TLTB.

To prepare the land, approximately 16,000 cubic meters of soapstone was used to backfill and stabilize the area, paving the way for the development of a fully serviced subdivision.

Our goal was to ensure that the landowners of mataqali Vunitavola benefit from the highest and best use

of their land – now aligned with long-term landowners’ empowerment.

This project is a testament to what can be achieved when landowners and the Board work together to unlock the true value of itaukei land. This milestone reflects our continued commitment to landowner empowerment through the utilisation of itaukei land. ■



Senior Valuer Mr Ilaisa Kalivari with his certificate

Building Capacity for TLTB’s New Business Direction

In a proud moment for the iTaukei Land Trust Board (TLTB), we are pleased to share that Mr. Ilaisa Kalivari from our very own Valuation Department have been officially awarded his Registered Valuer (RV) certificates by the Valuation Registration Board (RVB).

This achievement not only marks a personal achievement for Mr. Kalivari but also reflects TLTB’s broader commitment to strengthening in-house expertise as we embark on our New Business Direction. By building

valuation capacity within the organisation, we enhance our ability to support landowner-driven development, strategic land use planning, and wealth creation through accurate and independent property valuation.

Additionally, Mr. Laisenia Talavutu of our Sigatoka/ Western Office has completed his final practical interview and is one step closer to joining the ranks of Registered Valuers. His progress highlights the talent pipeline within TLTB and our focus on professional development.

We are also working toward having at least 2–4 more internal candidates sit their final oral interviews by

November 2025, once they complete and submit the required seven (7) valuation reports.

Accurate land valuations are a cornerstone of landowner empowerment, and we're committed to growing

our capacity to serve landowners better—now and into the future. ■



Executive Managers, Senior Managers and landowners at Burebasaga

Senior Managers Meeting & Talanoa Session to Burebasaga

On Monday 16 June 2025, the iTaukei Land Trust Board (TLTB) held its Senior Managers Meeting at the historic village of Burebasaga in Rewa – the village that lends its name to one of the three Confederacies – the Burebasaga Confederacy.

At this monthly gathering, all executives and senior managers reviewed their performance and mapped out strategies for the months ahead. But beyond the meeting, the real highlight of

the day came after lunch – with a vibrant Talanoa session involving the nearby villagers of Waivou, Naivikisara, and Suva Lailai.

One of the most encouraging outcomes was the interest shown by local women's groups, who asked how they could access the iTaukei Development Fund Facility (TDFF) to grow their small catering businesses.

CEO Mr Solomon Nata praised the village's efforts,

noting that their existing Burebasaga Cooperative gives them a strong platform to apply for the TDFF. With this, they could secure a tractor under the 1/3 – 2/3 payment model, where the cooperative contributes one-third and Government covers the rest.

The TLTB team will work to fast-track their application so that they begin mechanized farming, repay the loan, and expand into other ventures – including participating in the

nearby chilling centre and seeking support for school transport.

And of course, it wouldn't be Burebasaga without the delicious Tebara cuisine! Our staff were treated to local favourites like rourou vakautona and mana – a perfect end to a meaningful day of service and connection.

Empowering our landowners. Investing in our communities. One village at a time. ■



Court orders is TLTB's last resort

Court Orders to Dismantle Structures and Take Back Possession of Leased Land

The iTaukei Land Trust Board (TLTB) is committed to engaging with stakeholders and tenants through collaborative efforts in addressing outstanding lease rental payments. TLTB is pleased to announce a 26% reduction in rental arrears from \$31 million to \$23 million so far between 1st January 2025 and 31st May 2025.

Rent payment is a fundamental term and condition of leases and must be paid on time in January and June each year. Tenants have exclusive possession of the land to provide security, shelter, and livelihoods. The

landowners who allowed their land to be leased out are legally entitled to receive their rental return on time.

There are around 19,331 tenants that are in arrears with 6,276 for agricultural owing \$3.7 million and 13,055 for non-agricultural owing \$18.8 million.

Failure to pay rent can lead to legal action, including eviction from the land. Currently, 500 tenant cases are before the court to enforce payment, and in two instances, TLTB has obtained court orders to dismantle structures and take back

possession of the leased land.

TLTB urges its tenants to prioritise rent payments within their budget. TLTB is

also encouraging tenants facing difficulties in meeting rental obligations to contact their nearest TLTB office promptly to discuss partial payment plans. This initiative

aims to provide flexibility and support to tenants to mitigate financial burdens.

For payment convenience, tenants can visit any TLTB

office or make deposits through ANZ, BSP, Westpac, BRED, HFC Bank and payments via M-PAISA or at any Post Office, MH and Max Val-U outlets Fiji wide. ■



Landonwers of Tokatoka Namara in Nadi happy to receive their new mini-van from CEO Mr Solomone Nata

From Vision to Reality: Tokatoka Namara Gets Moving

The Tokatoka Namara of Moala Village in Sikituru, Ba, has taken a bold step into business by acquiring a brand-new licensed minibus through the iTaukei Development Fund Facility (TDFF) – with full funding of \$94,500.00 provided by TLTB.

Supplied by Asco Motors, this LM-registered vehicle will

now be used to provide daily transport for school children in the area – a vital service that also opens up long-term business opportunities for the Tokatoka.

Speaking on behalf of the Tokatoka, Mr. Levani Namoto expressed heartfelt thanks to TLTB for the timely support. “This assistance has changed

everything for us. We have now extended our business and a way to support our children’s education.”

CEO Mr. Solomone Nata applauded their initiative, saying:

“We can’t just sit and wait for change – we must shift our mindset, take action,

and build something for our people. That’s what this van minibuses represents.”

Congratulations to Tokatoka Namara for showing that with landowner empowerment, business dreams can hit the road running. ■

Toko 999-Year Lease Update

The iTaukei Land Trust Board (TLTB) wishes to clarify the reports recently published in the media regarding legal proceedings brought before the High Court in Ba against TLTB by persons purporting to represent lease holders in Toko. The proceedings seek to determine, among other things, the question of whether the Board has the powers to unilaterally surrender, cancel, or deal with the land without the consent of the sublessees and the occupants.

An application was also filed for an interim injunction for orders restraining the Board from surrendering, cancelling or otherwise dealing with the Toko leases or subleases. It is not uncommon for the High Court to order an injunction temporarily to allow parties to file their respective affidavits, for the interim injunction

application to be heard, and for the Court to determine whether to order an interim injunction. Such orders, if granted, are intended to maintain the status quo and preserve the rights of the parties until the substantive action is finally determined.

There were reports in the Fiji Sun on 30 May 2025 titled ‘TLTB Stopped from Ending Toko Lease’ and The Fiji Times titled ‘Judge: Hands Off Lease!’ on 2 June 2025 on the High Court action. The headlines insinuate incorrectly and quite unfairly that TLTB did, in fact, attempt to end the Toko lease by presenting to the Registrar of Titles a surrender of the Toko lease and/or Toko subleases or otherwise attempted to cancel such lease. TLTB categorically states that the headlines are both misleading and factually incorrect. ■



Tenants of Toko in consultation mode

TLTB reiterates that it has always endeavoured to work collaboratively with the landowners and tenants to arrive at an equitable arrangement that benefits both the landowners and

tenants alike. The matter is currently before the Courts and therefore remains sub judice. We urge the media to be responsible in its reporting and maintain proper legal and ethical reporting standards.

TLTB affirms its position that no action will be taken to arbitrarily remove any of the residents of the Toko lease nor does it intend to dispossess residents of their occupation of the land. TLTB will in the meantime,

cooperate fully with the orders and directions of the Court and await the Court's determination of the substantive action. ■



CEO Mr Solomon Nata with Software Factory CEO Mr Semi Tukana

Software Factory to Develop New Loan Management System

As part of its new business direction, the iTaukei Land Trust Board (TLTB) has taken a significant step to strengthen the delivery and management of its Taukei Development Fund Facility (TDFF) loans by partnering with Software Factory Ltd (SFL) to develop and implement a dedicated loan management system.

With more than 60 iTaukei individuals and landowning units already part of the TDFF loan portfolio, TLTB CEO Mr. Solomon Nata stated that it is now critical to establish a reliable and modern system to manage

loan disbursements, track repayments, and monitor borrower performance.

"We believe it is only proper to get a purpose-built platform in place that allows us to efficiently manage the entire lifecycle of these loans and provide better support to our landowners," said Mr. Nata.

The new system, known as LoanWorksNGX, will be designed and deployed by Software Factory Ltd, an iTaukei-owned software company with a strong track record in fintech solutions. SFL CEO Mr. Semi Tukana confirmed that the contract

includes the following deliverables:

- Full loan lifecycle management (from application to closure)
- Unlimited user licenses with mobile accessibility
- On-site hosting and cloud integration
- Training for TLTB staff (including IT, Finance, Trust, and TDF teams)
- 30-day post-implementation support
- Compliance with Reserve Bank of Fiji standards and ISO27001 information security protocols

Mr. Tukana added, "We're proud to support TLTB and contribute to this visionary step in empowering iTaukei landowners. This modern solution is designed to boost efficiency and financial transparency while helping landowners thrive in the areas of commerce and investment."

The new credit facility and loan management system is scheduled for launch in July 2025, setting the foundation for smarter, secure, and inclusive financial services under TLTB's evolving mandate. ■

Mataqali Nayavulagilagi Invests Timber Royalties into Tractors

The iTaukei Land Trust Board (TLTB) has reaffirmed its commitment to empowering landowners with the successful handover of two tractors to the Mataqali Nayavulagilagi of Draiba Village, Namataku District in

the highlands of Navosa.

Funded from timber royalties held in trust by TLTB, the Mataqali chose not to adopt the Equal Rent Distribution (ERD) system, allowing them to accumulate sufficient



Another leap forward for Mataqali Nayavulagilagi

funds to invest in machinery that will directly benefit their LOU members. The two tractors, valued at more than \$100, 000, will support the Tokatoka of Nayavulagilagi and Lokuvura as they transition from subsistence to commercial farming.

TLTB CEO Mr. Solomon Nata, handed over the keys to representatives of the two Tokatoka at Global Machinery

in Suva. He praised the initiative as a demonstration of landowner-led development and strategic use of land lease proceeds.

"This is a powerful example of how lease funds and trust accounts can be reinvested to create long-term economic growth for our iTaukei communities," said Mr. Nata. "It reflects our objective to create wealth for the

landowners and alternative pathways TLTB offers to help our people achieve economic self-reliance."

Mr. Waisea Colanuku, a representative from the Mataqali, expressed heartfelt gratitude during the handover, calling it a turning point for their village. "We've been farming with knives and forks, but today we take a huge step forward. We're

thankful to our forefathers who allowed the lease for logging, and to TLTB for making this investment possible. We hope this is only the beginning."

TLTB will continue to support landowners in identifying ways to reinvest their earnings for maximum impact and long-term sustainability■



Embraces Modern Mapping Technology

After 15 years of using the old Trimble GPS, the iTaukei Land Trust Board (TLTB) has made a major leap forward by upgrading to 13 brand-new P6H GNSS handheld units!

These new devices run on Android and come equipped with the Survey Master App, offering powerful tools like:

- Road surveys
- Navigation
- Topographic surveys
- RTK features that improve accuracy down to 8mm

They're also compatible with Survey 123, Field Maps, and other ArcGIS Online apps – making it easier for our field

teams to map and survey iTaukei land with unmatched precision and efficiency. Our LeaseMaster layer can now be uploaded onto these devices so our teams can navigate and conduct surveys faster and smarter!

Compact, rugged, and reliable – the P6H handhelds are tailor-made for the kind of field work our staff do (across the regions) every day.

The devices have already been tested and proven through trials with the latest models from ComNav Technology Ltd. – making land service delivery better for our landowners and tenants! ■



The new P6H GNSS handheld



CEO Soloone Nata with members of the Fijian delegation holding discussions in PNG during the recent Government Tour

TLTB at Fiji-PNG Business Mission

The iTaukei Land Trust Board (TLTB) is honored to have been part of the recent Fiji-Papua New Guinea Business Mission, held from the 24th to the 26th of March in Port Moresby. This important mission was led by the Deputy Prime Minister, Hon. Manoa Kamikamica, and facilitated by Investment Fiji. It served as a milestone moment not only for the Fiji delegation but also the TLTB team who gained valuable insights into the dynamic world of regional trade, business leadership, and strategic investment.

The TLTB team, consisting of CEO Mr. Solomon Nata, EO Samu Newa, and LRO Senimili Botitu, were selected by their respective Divisional Managers to represent the Estate Services and Landowners Affairs Division. The delegation departed from Nausori and traveled through Nadi and Brisbane before reaching Port Moresby.

Day One: Strategic Briefings

Held at the Hilton Hotel, the first day was dedicated to a private briefing session with prominent business leaders, including:

- Mr. Pradeep Lal, Regional CEO of Vodafone PNG, who shared the company's successful business journey and

investment outlook in healthcare, education, and agriculture.

- Mr. Pradeep Panda of CPL Group, representing one of PNG's most successful retail conglomerates, founded by Fiji-born Sir Mahesh Patel. He emphasized health, food, and lifestyle services.
- Mr. Clarence Hoot, Managing Director of Investment Promotion Authority PNG, who highlighted business risks and growth potentials.
- Business Advantage International representatives spoke about PNG's economic journey and opportunities moving forward.
- Mr. Michael Nacola, Managing Director of BSP Life, presented future strategies for regional financial growth.

Day Two: Business Forum at APEC Haus

The official Business Forum saw opening remarks from First Secretary Ms. Rosa Dalitucama, who emphasized the significance of the mission in strengthening Fiji-PNG relations. Deputy Prime Minister Hon. Kamikamica thanked the Motu and Kaitapu landowners and stressed the importance of this mission in opening up new business opportunities

across both nations.

Sir Mahesh Patel, as keynote speaker, delivered a powerful message to entrepreneurs:

- Take risks and stay adaptable.
- Build with impact, not just for profit.
- Commit to lifelong learning.
- His call to drive innovation and sustainability resonated strongly with the entire delegation.

Day Three: Site Visits



the importance of local produce from PNG's highlands, reinforcing the idea that agricultural empowerment can drive economic development.

This mission reinforced the importance of regional trade, agricultural investment, and strategic partnerships. The knowledge gained is critical not only for our personal growth but will greatly benefit landowning units in Fiji. It highlighted how vacant land can be transformed into productive agricultural assets, thereby supporting

1. CPL Warehouse, Waigani – The team toured CPL's central warehouse and observed operational logistics, workforce coordination, and the supply chain of local produce—a powerful insight into community-based business models.
2. CPL Supermarket – The team witnessed firsthand

national food security and rural livelihoods.

In the coming days, a full report will be submitted to Executive Management with practical recommendations based on the mission's outcomes, including opportunities raised during the Talanoa session with the Fijian diaspora in Port Moresby.



Landonwers Workshop moves to Vanua Levu with the issuance of their Asset Capitalisation Report

Empowering Landowners: Nakama Workshop in Macuata

The Landowners Empowerment Department successfully hosted its second Landowning Unit (LOU) Workshop of the year marking the first of three workshops scheduled for the Northern Division. Centered on the theme “Empowering Landowners for

Successful Implementation & Sustainability of Development Projects,” the event brought together key stakeholders in the village of Nakama, Wailevu, Macuata.

Fifteen landowning units were invited to participate alongside representatives

from various Government Ministries and private institutions. The workshop aimed to foster awareness and collaboration among stakeholders, ensuring landowners are well-equipped to lead and sustain development initiatives on their land.

A participant expressed gratitude, stating, “Most of us present today are hearing about these assistances and initiatives for the first time. We are grateful to be part of the workshop as it has exposed and broadened our understanding of how to utilize the resources available on our Mataqali lands.”

The workshop focused on three primary objectives:

1. Engaging stakeholders to align on development priorities of each Landowning Unit.
2. Sharing current and future initiatives designed to support landowners.
3. Exploring opportunities for collaboration to enable the successful implementation and sustainability of community-led projects ■

The event started with a devotion by the Village Pastor and was officially opened by the General Manager of Landowners Affairs Mr. Peni Qalo. Participants were later presented with their individual Asset Capitalization Reports, a key tool in helping them assess and leverage the value of their land-based assets.

In his closing remarks, a representative from the Macuata Provincial Office commended the initiative and underscored the importance of landowner engagement in the country’s broader development agenda.





Women empowerment is also one of our key targets

224 Women Given iTaukei Leases in 2025

The iTaukei Land Trust Board (TLTB) continues to take bold steps towards promoting gender equality in land access, with 224 out of 1,301 leases issued so far going to women as at end of June 2025. This includes 117 iTaukei women and 107 are women from other races; a strong indicator of TLTB's commitment to inclusivity and fair opportunity. Out of the 224 iTaukei women leases, 24 are members of their landowning unit leasing their own land.

CEO Mr. Solomon Nata said that these efforts are part of TLTB's broader strategy to

ensure women are not left behind in the economic use and ownership of land leases.

"Our goal is to remove systemic barriers and ensure women—whether iTaukei or other race—have equal opportunity to access land for residential, agricultural, or commercial use. This aligns directly with our Strategic Corporate Plan 2025–2029, which commits to equity and empowerment for all land users," Mr. Nata said.

Traditionally, access to land in Fiji has been male dominated, especially in customary settings. However,

TLTB is actively working to change that narrative through targeted outreach, simplified leasing processes, and community education programs to encourage women applicants.

The move reflects Fiji's commitment to the UN Sustainable Development Goals (SDGs), particularly Goal 5: Gender Equality, and supports broader national efforts to build an inclusive and just society.

Mr. Nata reaffirmed that TLTB will continue to lead by example by embedding inclusivity into its daily

operations, lease approvals, and land development support services.

"Women have always played a vital role in our communities and economies. Giving them access to land isn't just fair—it's smart development," he said.

TLTB is calling on communities, landowners, and development partners to support this movement by encouraging more women to apply for leases and by eliminating cultural or institutional biases that may stand in their way. ■

TAUKEI PLAZA DUA

Premium Office Space – Opposite the Lautoka Bus Stand!

Move your business to the heart of Lautoka with 61sqm of modern office space – perfect for growth, visibility, and success.

- 12 adaptable office units
- Prime Tukani Street/Vaqalo Street location
- Professional setting with parking
- Ideal for startups, agencies & branch offices
- Fully fenced and secured
- 24 hour security with lights
- Backup generator included

Don't miss out on this high-traffic, high-potential space!

Call Property Officer, Mr. Ledua Vakayatu on +679 9988611 or email lvakayatu@tltb.com.fj to book a viewing today!

COMMERCIAL SPACE FOR RENT

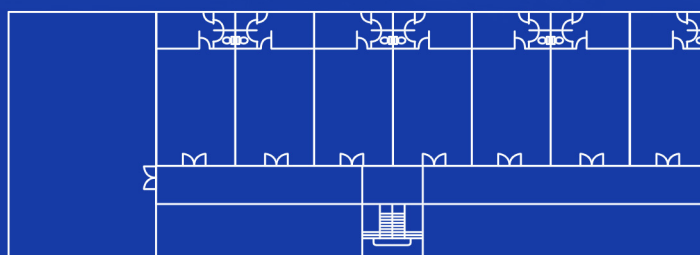



ITAUKEI
LAND TRUST BOARD

GROUND LEASE PAYMENT OPTIONS

THE FOLLOWING TLTB OFFICES ARE OPEN FOR DIRECT PAYMENTS:
SUVA, NADI, LAUTOKA, NAUSORI, RAKIRAKI, BA, SIGATOKA, LABASA, KOROVOU
AND SAVUSAVU OFFICES.
Mon - Fri 8:30am - 3:00pm

*TLTB Tenants should provide Lease Reference (**Lease Account No. or Lease File No. or File Ref Number**) when making payments to **Banks, Post Fiji, MH or Max Val-u** to ensure your account is updated in a timely manner. Please note that we do process payments on a daily basis for bank accounts that have been provided on your invoice lease statement.*



Bank Account:
1230137
ANZ Swift Code:
ANZBFJFX



Bank Account:
000128850046
WBC Swift Code:
BREDFJFJ



Bank Account:
9803367755
WBC Swift Code:
WPACFJFX



Bank Account:
8066882
BSP Swift Code:
BOSPFJFJ



Any Post Fiji Outlet



Any MH FIJI Outlet



Any Max Value FIJI Outlet



Please ensure to include your lease reference (lease account number or lease file number) when making your payments using the bank accounts mentioned. Alternatively please send an email to info@tltb.com.fj to advise us that you have made a payment together with the payment receipt from your bank. For any queries on making lease payments, email financialteamfinance@tltb.com.fj and the team will respond within one working day.

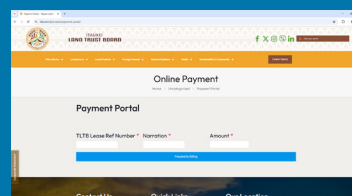

For visa card payment, TLTB offers the following facility on tltb.com.fj under payment options and online payment to make payments.